

SCREEN PRO®

MOTORIZED SCREEN SERIES

USER MANUAL

E-TYPE

- * Please read this instruction manual carefully before connecting, operating or adjusting this machine.
- * Please keep this manual in a safe place for future reference.

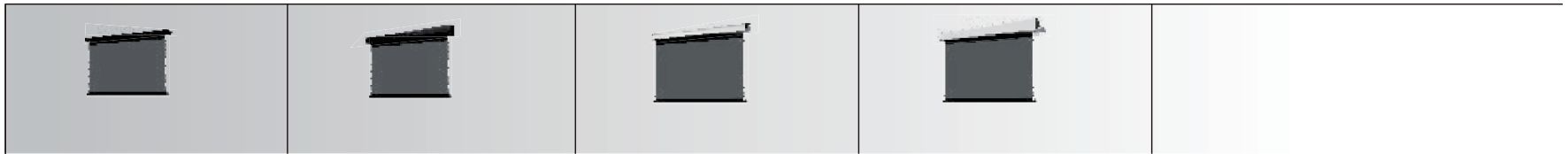

TO THE OWNER

Thank you for purchasing our quality screen that uses fine fabric and mechanical components to give you trouble-free enjoyment for years. Please read this specification detailedly before installation and usage. Design and specifications are subject to change without notice.



SAFETY GUIDE

1. When assembling, it is forbidden to stand underneath the screen to avoid any hazard. Expansive bolt should be firmly punched and fixed into the wall or ceiling. 2. Be sure the screen is connected with grounded outlet to avoid any possibility of electric shocking.



REMARK

1. Do not run the screen continuously over 4 mins (Overheat protection feature would stop the motor in case of overheat. You may operate the screen again after the motor cooled down in about 20 minutes).
2. Do not scratch or fold up the fabric.
3. After usage, please check and confirm the cleanness of the screen, surface before retracting the fabric.
4. Matte white surface is washable with a soft towel moistened with water or weak alkaline detergent diluted liquid (Do not use alcohol or ether liquid to wash).

Parts	Ash	Impurity
Casing	Rid the little dusty with feather duster	Clean with a mild soap solution, then dry with cotton cloth, take care to avoid casing scratching
Fabric	Clean the dusty with feather duster	Brush the dirty with cotton cloth

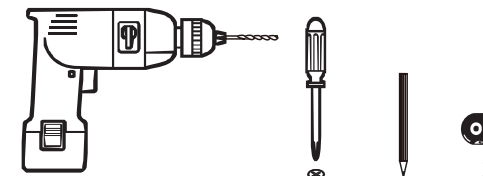

GUIDANCE

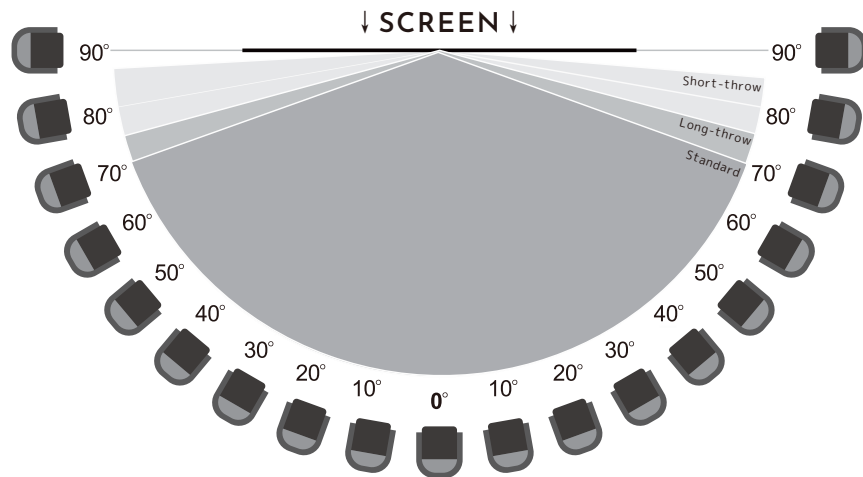

Short-throw screen user please pay attention to the direction of the screen.
The screen will change according to the installation position of the projector.
The recommended viewing distance is more than 2m

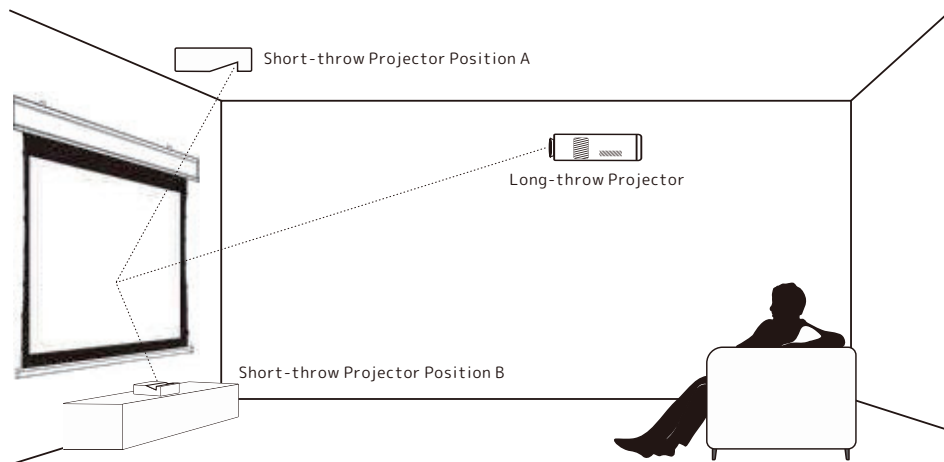

ATTENTION ! WHEN YOU SEE A " ⚠ WARNING SIGN " BE SURE TO HEED THE MESSAGE !

SCREEN CARE

WARNING!

Do not touch the screen directly with your hand, skin grease will cause damage to the screen coating. Avoid sharp objects from directly touching the screen surface to avoid puncturing or scratching the screen surface.- Do not use acetone, benzene, alcohol, etc. to clean the screen with organic solvents, which will cause permanent damage to the screen.
Avoid scratching the screen surface, which will cause irreparable damage

Short-throw Fabric:

For general dust, use a soft brush to clean the screen surface.
Use soft cloth to dip with mild soapy liquid or neutral detergent.
Rough object or cloth may damage the screen surface.
Screen surface has optical textures, please wipe the horizontal direction when cleaning the fabric; do not wipe it vertical direction or revolve.

Wet cleaning: with a soft towel moistened with water or diluted detergent (Do not use alcohol). Compressed gas duster is recommend.

Acoustically Transparent Fabric:

Compressed gas duster is recommend.
Dust off the screen with a dry rag. Do not use wet cloth, detergent, etc. to wipe the dust on the curtain surface.

Long-throw Fabric:

Surface can be cleaned as follows:

1. Using a white clean cloth (100% cotton preferred) that is dampened with clear water, gently wipe the area in one direction. Do not use a circulate motion. Using a dry 100% cotton cloth, wipe dry after each cleaning and before folding and storing.
 2. To clean a stubborn stain or sticky surface, use denatured alcohol (methanol or methyl alcohol) following the same procedure as for water.
- OR.

1. Lint-Free white cloths, Mild Soap (hand soap is suitable) and Water.
2. Take the Lint-Free cloth and submerge it in warm water for cleaning light dust and dirt. For stubborn stains or a sticky surface, a solution of mild dishwashing liquid diluted with warm water should be used.
3. Completely ring out the cloth so it is lightly dampened, not drenched.
4. Using the damp cloth, lightly wipe in an up and down motion starting at the left of the screen moving to the right of the screen. DO NOT WIPE IN CIRCULAR MOTION.
5. Once you have completed wiping the entire screen with a dampened Lint-Free cloth, use the dry Lint-Free cloth to wipe off any excess water from the screen.

Standard Fabric:

Using a white clean cloth (100% cotton preferred) that is dampened with clear water, gently wipe the area in one direction. Do not use a circular motion. Using a dry 100% cotton cloth, wipe dry after each cleaning session. To clean a stubborn stain or a sticky surface, use denatured alcohol (methanol or methyl alcohol) following the same procedure as for water.

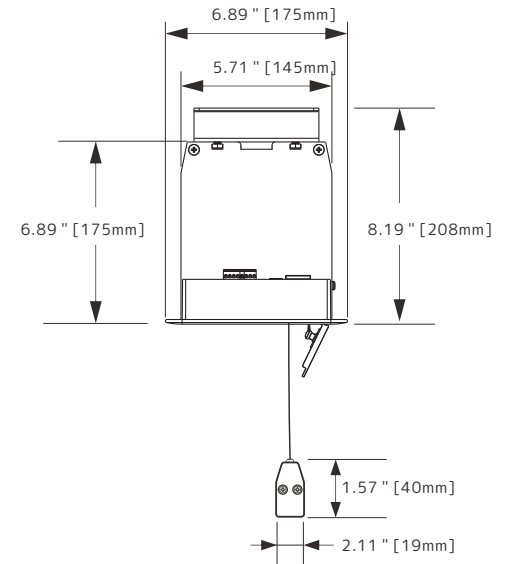

PARTS

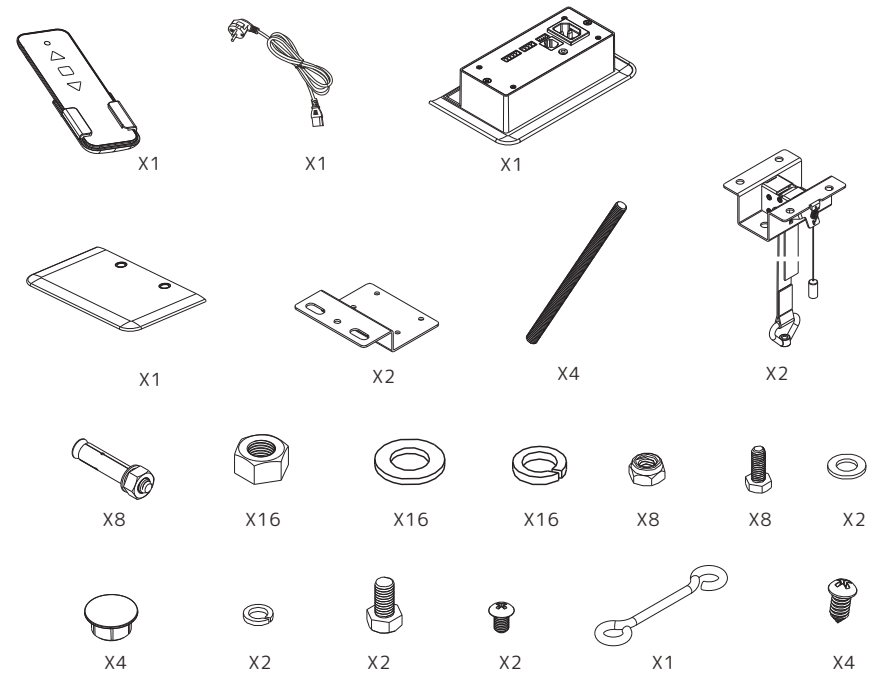

INSTALLATION

1. Grille ceiling mounting method

- (1) Select the appropriate installation location(fig1)
- (2) Remove the relevant ceiling
- (3) Measure the distance from ceiling to ceiling(fig2)

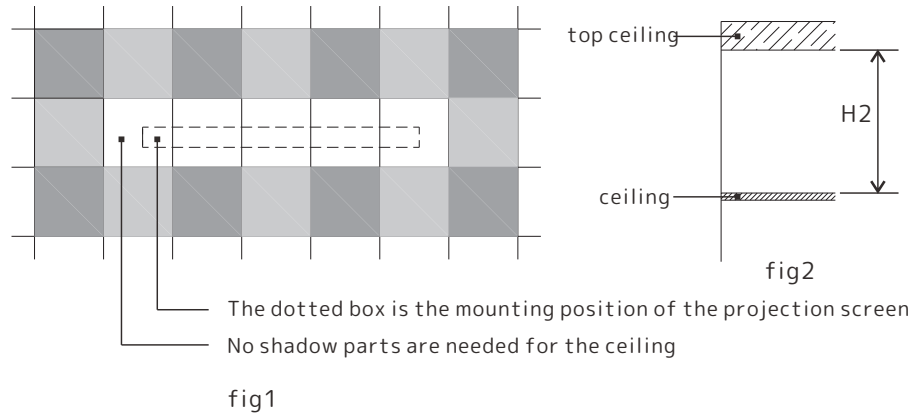

1.1 Wooden ceiling

- (1) Select the appropriate installation location(fig1)
- (2) Measuring screen length(fig3)
- (3) Groove according to the size of (fig 4)
- (4) Measure the distance from ceiling to ceiling(fig2)

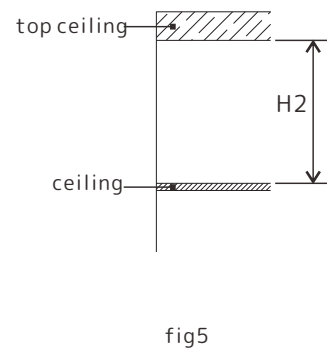
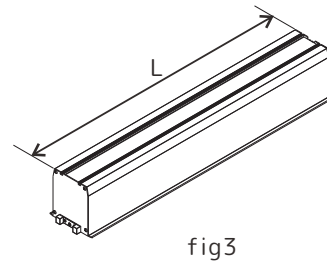
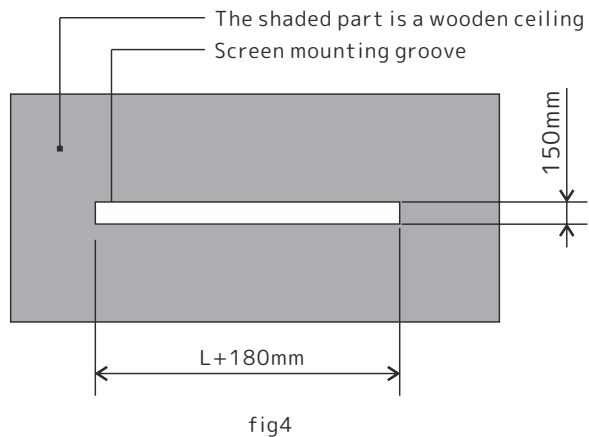

2. Install a trapeze

2.1 Assemble the screw

- (1) Cut the screw to a suitable length(fig6)
- (2) Connect the screw to the hanger and tighten the screw(fig7/fig8)

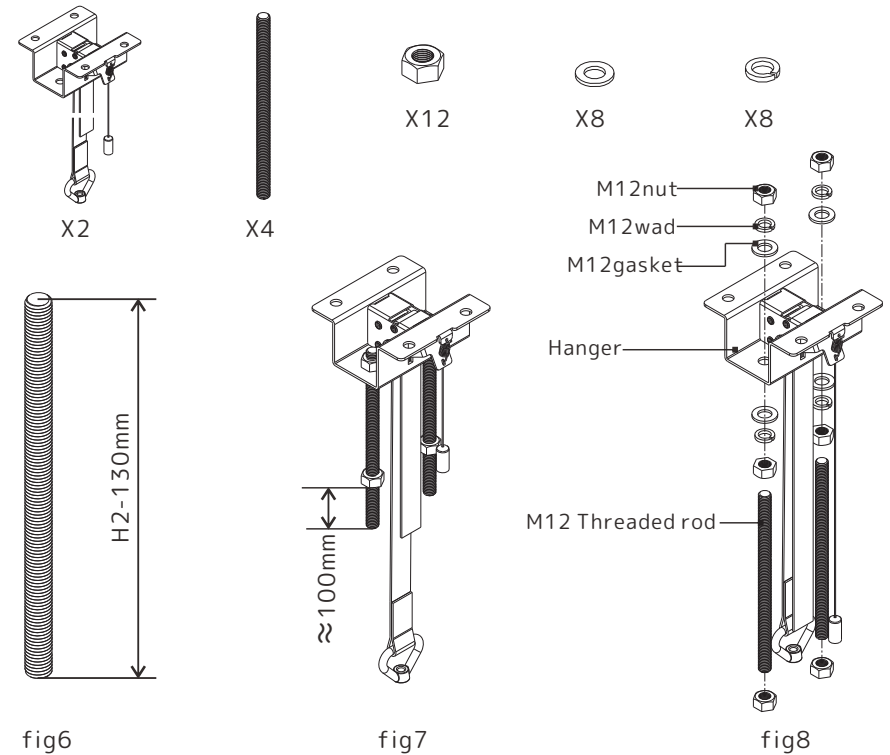

2.2 Drill the expansion bolt hole as shown below(fig9/fig10)

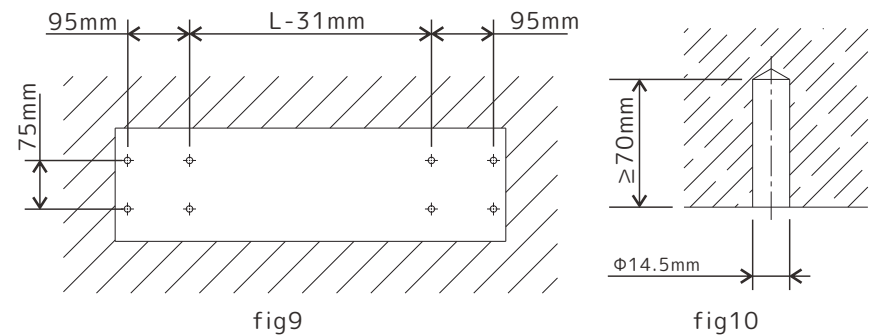

2.3 As shown, the hanger is fixed to the ceiling with expansion bolts(fig11/fig12)

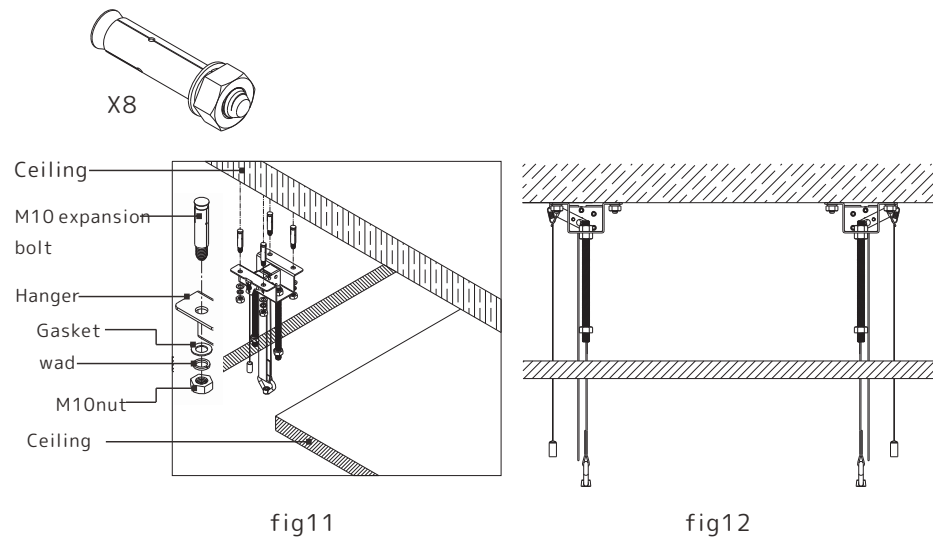

3.Install the screen

3.1 Install door actuator

- (1)Manually open the hatch door
- (2)Insert the lock pin into the drive band and screw through the lock pin into the lock pin rack

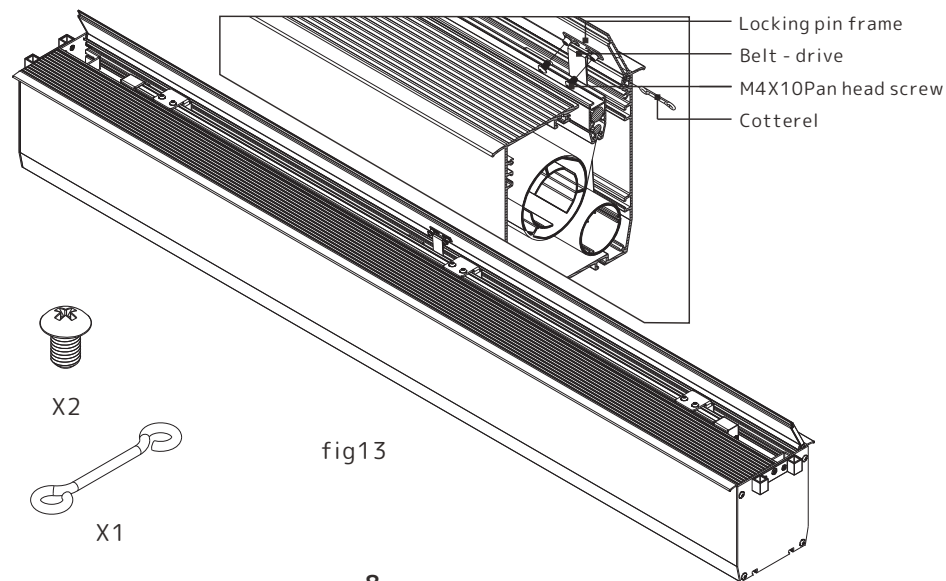

3.2 Remove the lower shaft retainer screws as shown below.

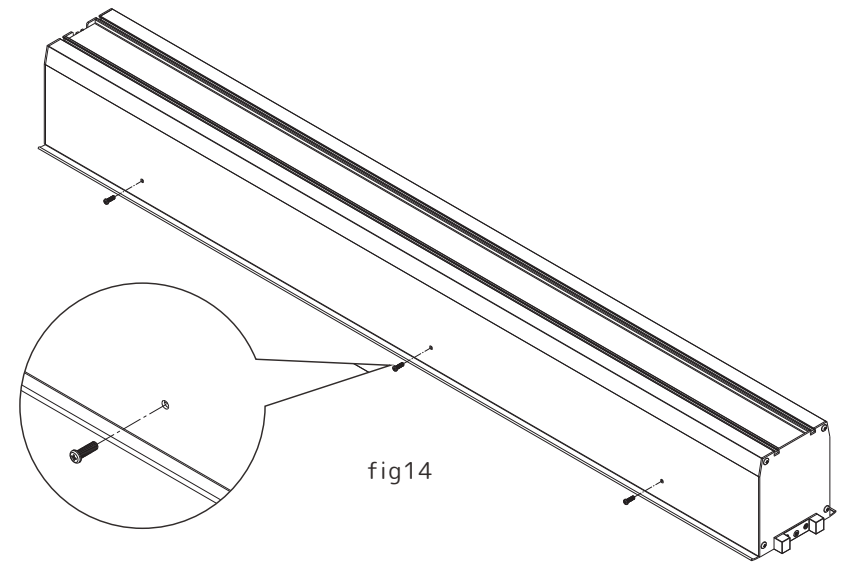

3.3 Mounting plate

- (1)Place the screw housing in the screw groove (Fig15).
- (2)Insert the lifting plate into the screw and fix it with a nut (Fig16).

Install it as shown in Figure 17.

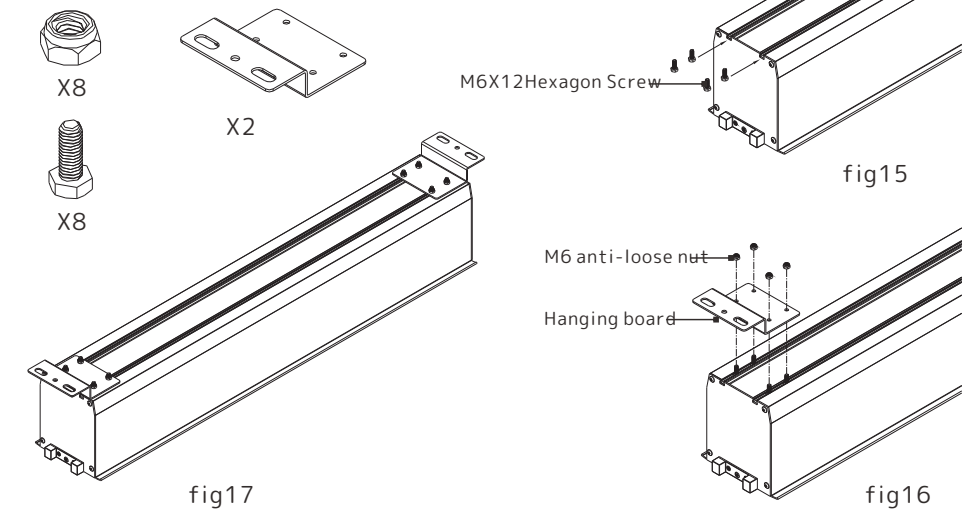

3.4 Secure the lifting eye to the lifting plate as shown in Fig18 and 19 and tighten the screws.

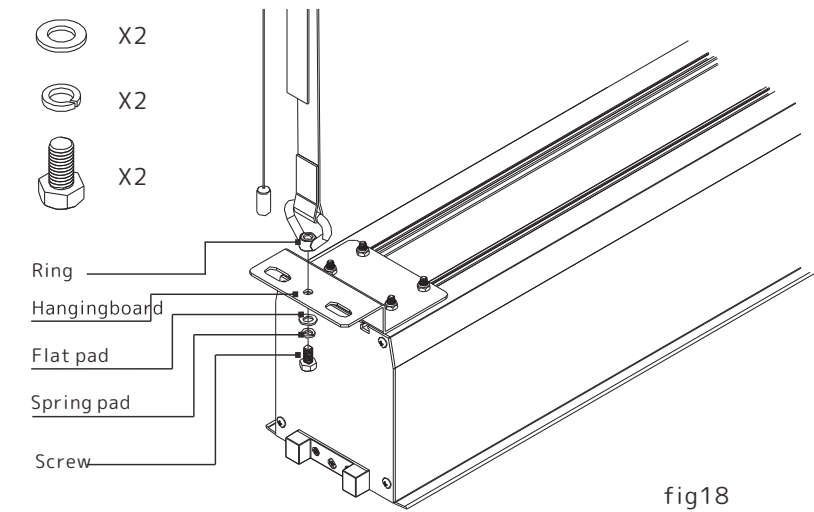

fig18

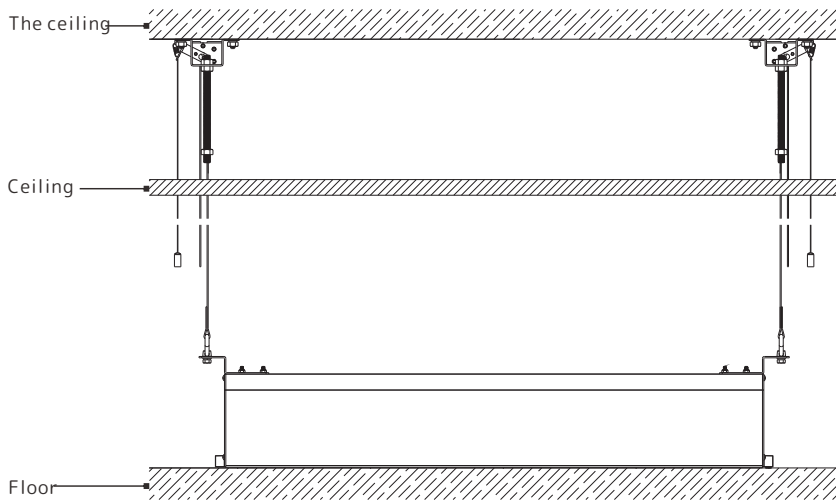

fig19

4. Connect the power plug and motor terminal as shown

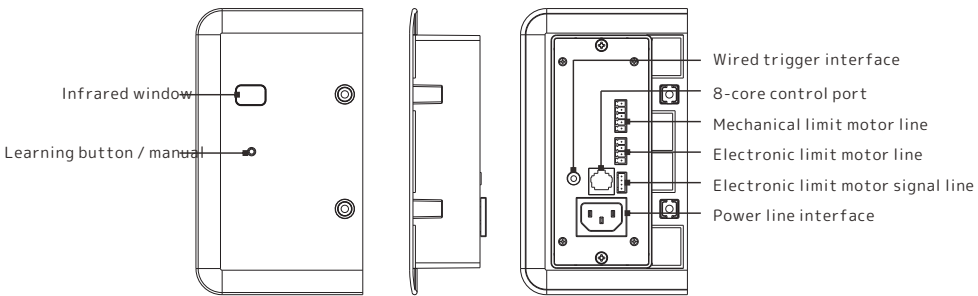

fig24

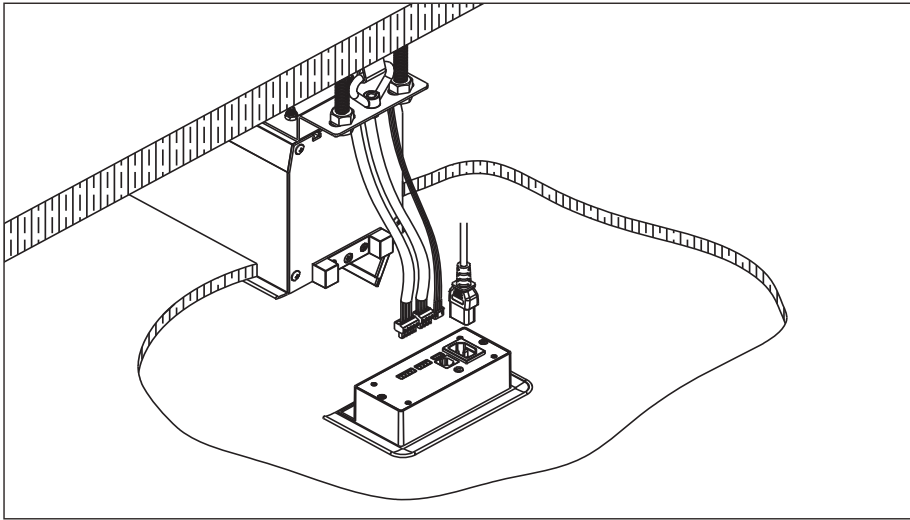
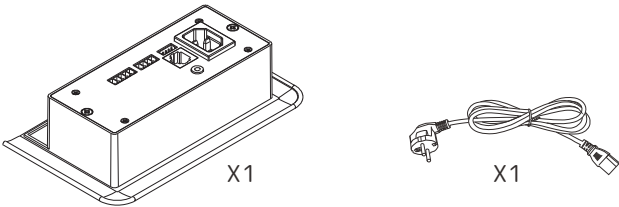

fig25



X1

X1

3.5 Upgrade screen

(1)How to use the hanger

A.Pull up

Push the lifting belt hard to pull the screen down and pull up
After the predetermined position, slowly release the hand to prevent the lifting belt from slipping and cause silver. The curtain fell. In the process of pulling up, I feel that I need to pull down.Pull the release cord down and start pulling up again. Attention to pull,When lifting the rope, the lifting belt should not be loose to prevent the screen from falling straight.

B.Decline

If you need to lower the screen during the installation process, first pull the liftLift the belt and then pull the release cord down and lift the belt along with the screen Gravity drops. Pay attention to the lifting belt when pulling the rope Stop the screen straight.

(2)Pull the lifting belt to pull the screen up, and ensure that both sides of the screen rise synchronously during the process of pulling up.

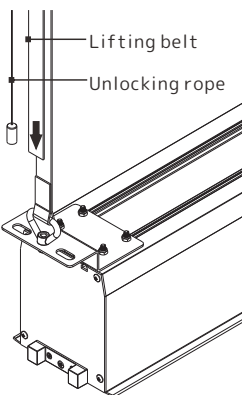

fig20

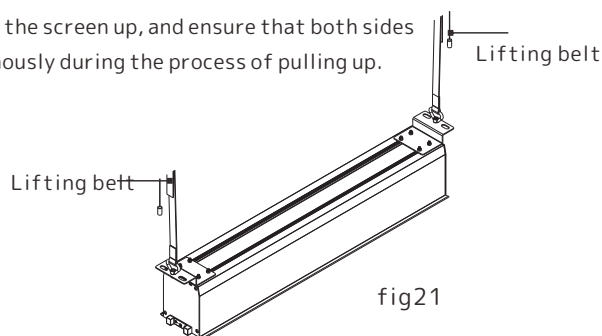

fig21

(3)Align the screen hanger with the screw and screw it into the nut. Adjust the gap between the screen edge and the ceiling to adjust the nut to the lock nut. After locking the nut, place the lifting strap and the unlocking cord on top of the ceiling.

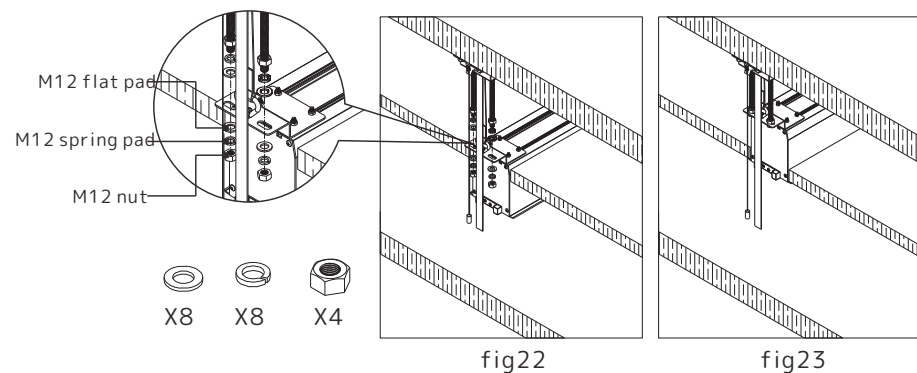

fig22

fig23

5. Install the left and right decorative cover as shown in the figure and tighten the screws. After the screws are installed,install the screw cover.

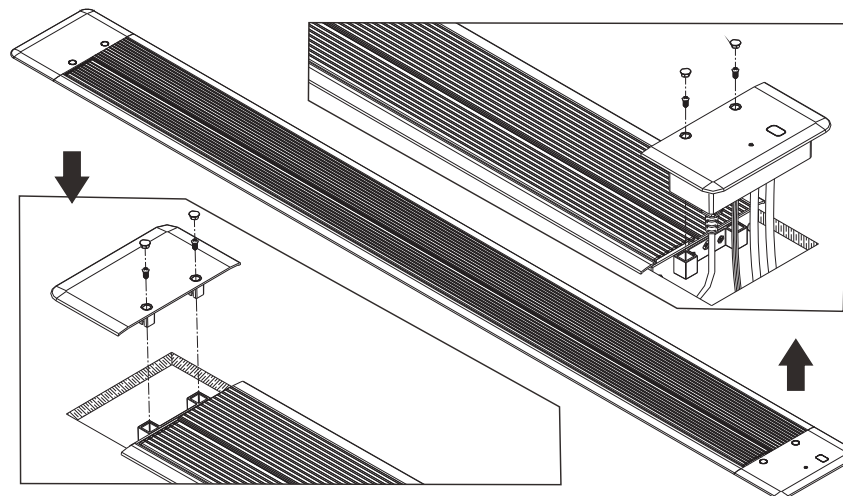
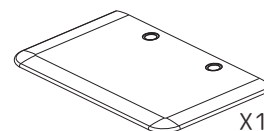
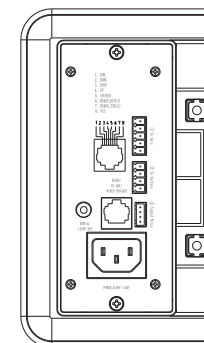
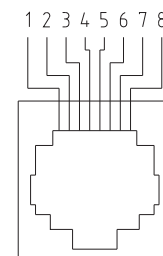

fig26



CONTROL PORT

1. COM
2. DOWN
3. STOP
4. UP
5. UNUSED
6. RS485,DCD(1)
7. RS485,TXD(3)
8. VCC



ADJUSTMENT

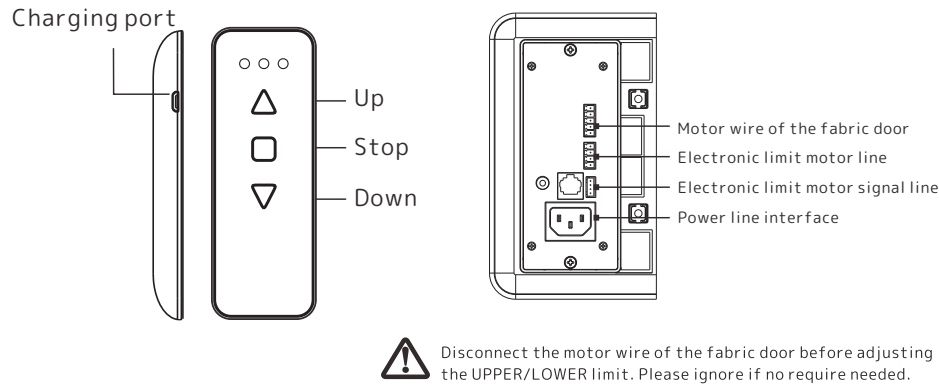

Programming Remote | choose one of two methods

Method A. Power on:

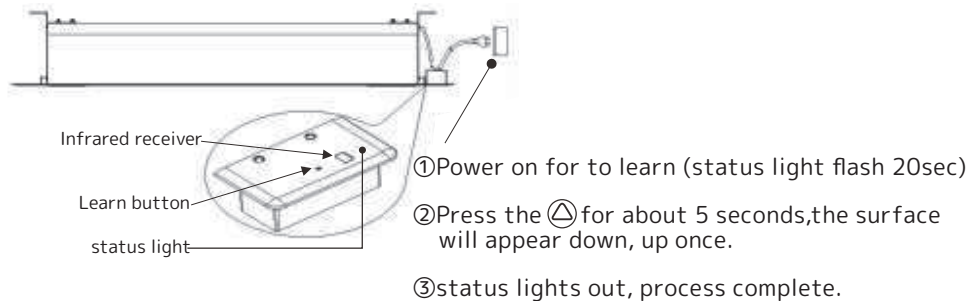

Method B. Press the Learn button:

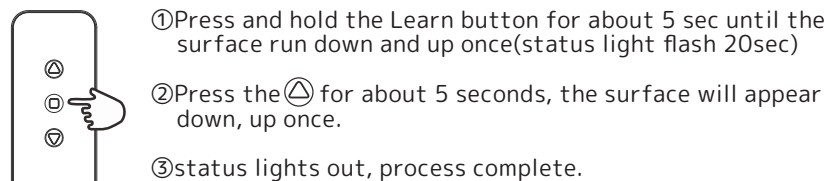

Please test on (operates the remote control screen ▲□▼) after adjustment, repeat the steps if need.

ADJUSTMENT AND USAGE

E-Type Motor Limit Setting

Child Lock Function:

The child lock function allows the screen itself to lock the mechanical structure so that the screen cannot be operated temporally. It is a safety feature that protects children, the elderly, and the frail from accidentally getting hurt when an unintentional operation.

1. State: If the projection screen runs down/up 3 times(uninterrupted), the screen will enter the protection state for 15 minutes automatically.
2. Debugging: Turn the power off and on again(unplugging and plugging back the power)

1.UPPER LIMIT Position

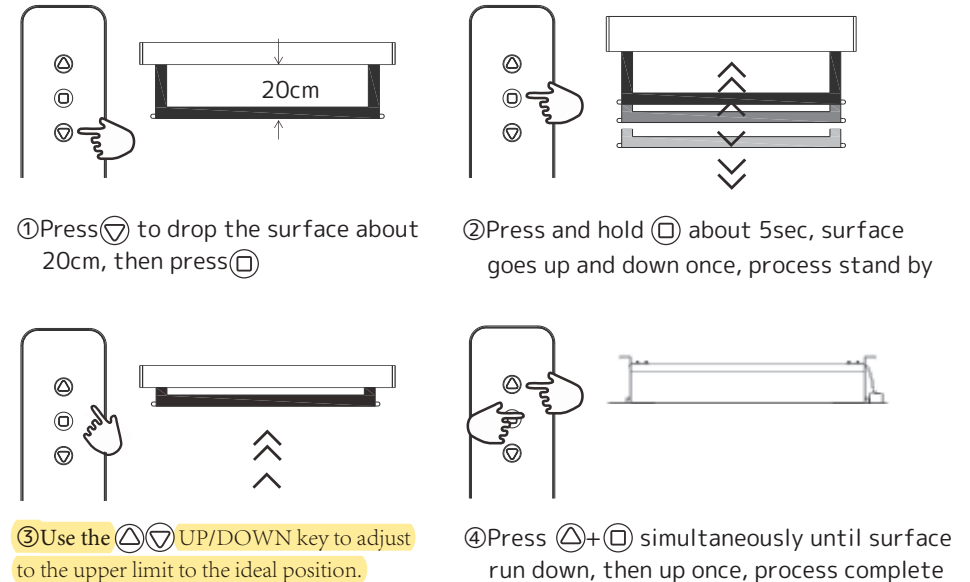

We do not recommended to make adjustments(only if necessary)

2. LOWER LIMIT Position

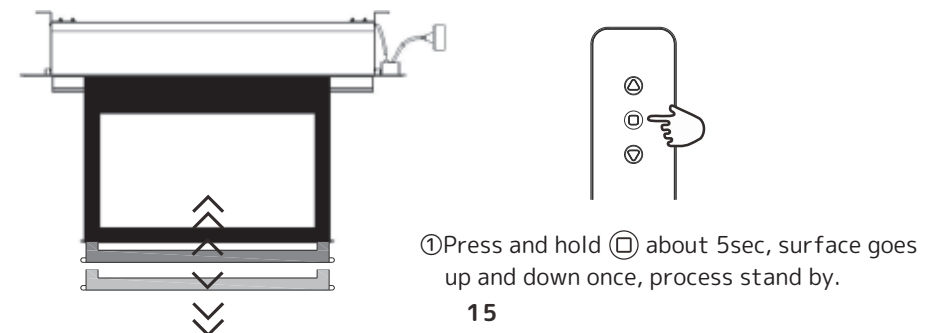

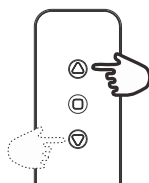

② Press ▲ or ▼ to adjust the black border to the desired height, until the screen is in the ideal place.

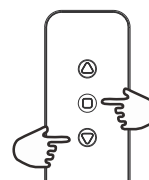
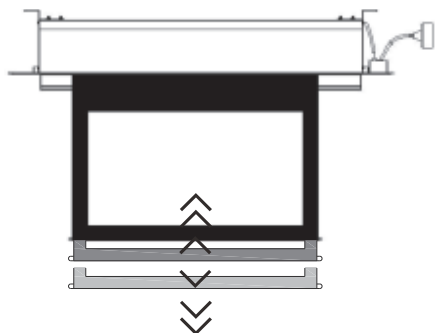

③ Press and hold ◻ + ▼ at the same time for about 5 sec, until surface go down, up once, process complete.

RESET (run reset function to restore factory settings position)

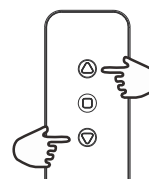

① Press and hold ▲ + ▼ at the same time for about 5 sec, until the surface retracts.
② fabric door closes automatically. *press the remote to test if reset successfully, if the screen doesn't respond the process is complete.

Clearing the Memory

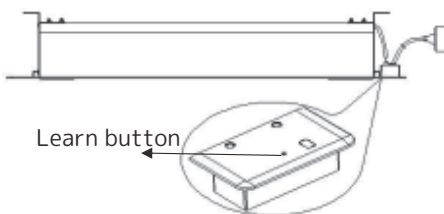

① Press and hold the "Learn" button, the screen will go ↑/↓ twice, release and clicking the "Learn" button once more afterward.

② Press the "Learn" button one more time the LED light go off, process complete.

SCREEN FLATNESS (A or B)

Trouble Shooting

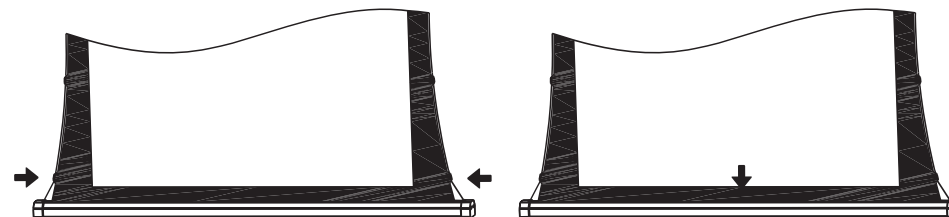

A.(L)

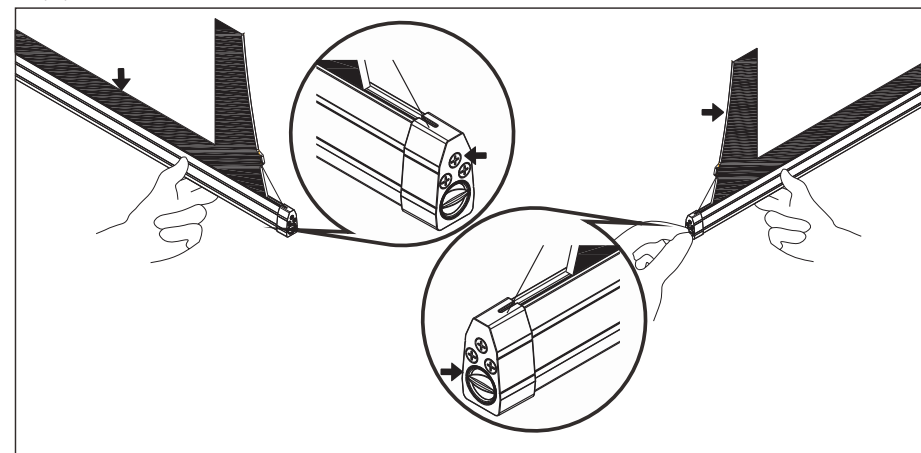

B.

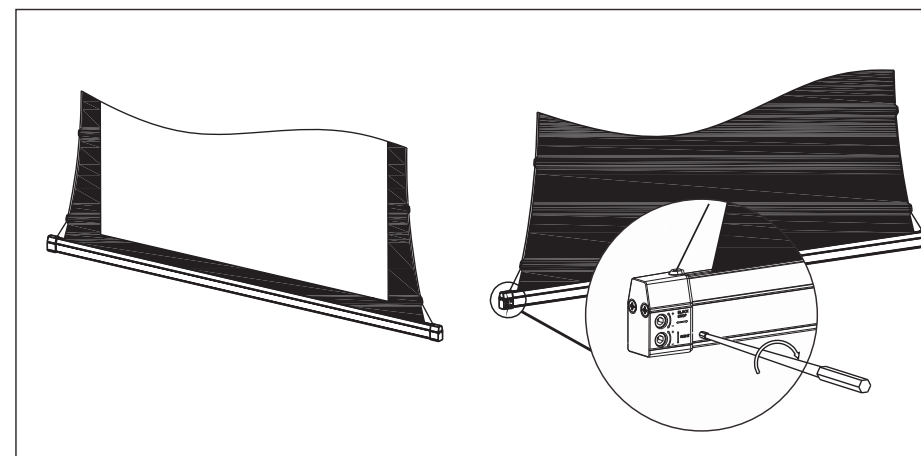

L/T: LEFT Tension

R/T: RIGHT Tension

BWT: Bottom Weight Bar

HOW TO FIX BROKEN TENSIONING STRING

A. When the tensioning string of the lower end is broken

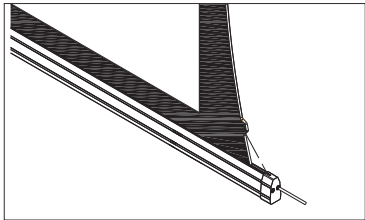

1. Unscrew the fixed screws and the screw of bottom weight bar, take the end cap of weight bar off.

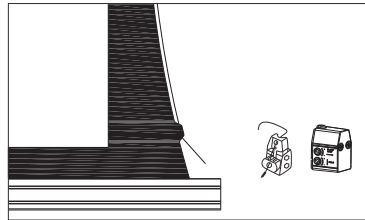

2. Unscrew the tensioning position screw and related parts.

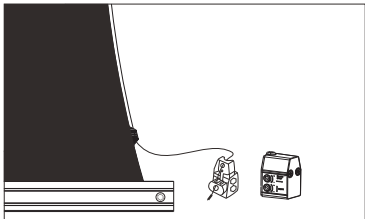

3. Pull the knob out and attach string again.

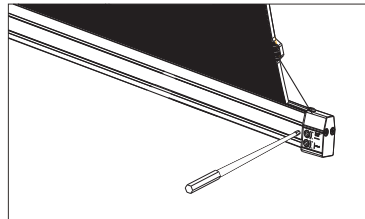

4. Adjust the string by rotating Accessory 3.

B. When the tensioning string of the upper end is broken

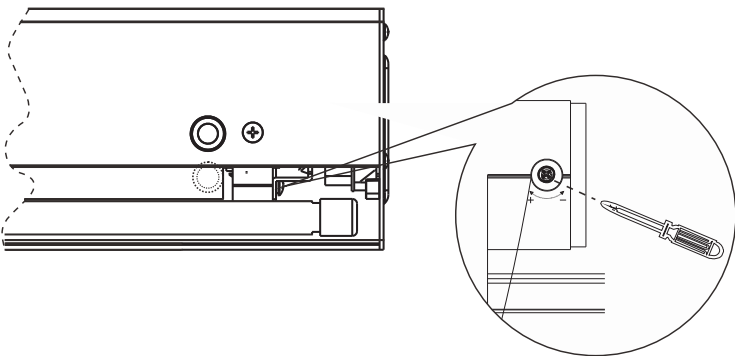

1. Unscrew the screw, attach the tensioning string again and screw up the screw.

SYNCHRONIZATION TRIGGER

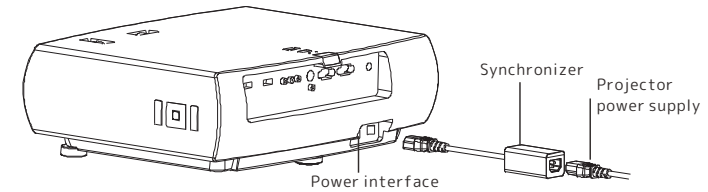

Code Learning(with screen):

Connect the synchronizer and power, turn on the projector, short press the "learn" button (the side cover of the screen cover) (≤ 3 seconds) until the screen automatically runs up. Press the "Set" button on the synchronizer to indicate The light flashes, the screen will run once at a time, release the "Settings" button, and the learning code ends.

Current memory:

Connect the synchronizer and power, turn on the projector. Press and hold the "Settings" button on the synchronizer until the indicator flashes from green flash to red flash to release the memory.

Delete code:

Press and hold the "learning" button (the side cover of the screen cover) for 7 seconds, release the button, press the "learn" button again until the screen automatically goes up twice, and the code deletion ends.

FAULT ANALYSIS AND ELIMINATION

A. Press any of the "Up", "Down" or "Stop" buttons on the remote control. If the indicator does not light, the remote control is low.

Try plugging in the charging power source for charging.

B. If the remote control cannot learn the code, please try to delete the code and learn the code again

(for the method, please refer to the debugging and use section of this manual).

C. If you can't control the screen with the remote control, but the internal relay of the screen has a "beep" sound.

please open the end cover to see if the wiring is in good contact. If the wiring is good, it is recommended to replace the motor.

If the relay is no noise, please replace the receiving board directly.

D. If the synchronizer (optional) does not control the screen, press the Learn button (the screen cover side cover)

until the screen automatically goes up and down. Press the Setup button on the synchronizer to see

if the indicator is flashing, if the synchronizer does not respond, Then try to replace the synchronizer.